



AX RANGE

- **"TAUR"** ECU
- **"SENTAUR"** PCU
- **"AX"** JOYSTICKS
- **"TM"** CHOPPERS



Icons legend



Scissor lifts



Articulated boom lifts



Telescopic boom lifts



Vertical mast boom lifts



Articulated platforms



Articulated push-arounds



Telescopic push-arounds

ECU

Electronic Control Unit

PCU

Power Control Unit



Scissor Lifts SYSTEM PROPOSAL



“SENTAUR”
multifunction controller PCU



Cable Harnesses



Compact scissor



“TM”
Traction Module



“TAUR”
multifunction controller ECU

“TAUR”

MULTIFUNCTION CONTROLLER ECU

P/N	Pkg Q.ty
1097017 TAUR-S1	1



Integrated 2-axis inclinometer



Customized “Lock vehicle” function for rental companies



System diagnostic function through the software



CAN Bus battery charger management function



Equipped with internal data logger managed by software



Use friendly guided menu for system setting & calibration

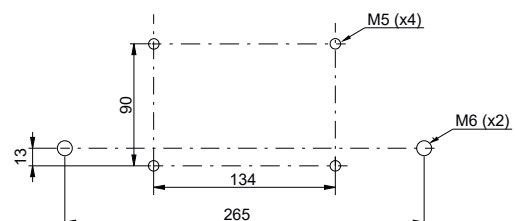
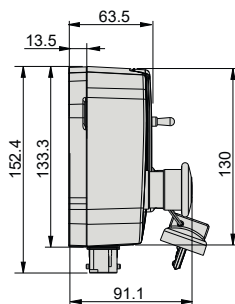
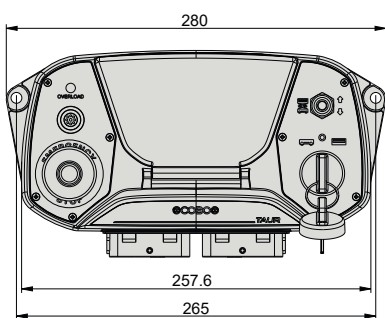

“TAUR”

MULTIFUNCTION CONTROLLER ECU



Door hinged on the lower side
Better access to the display,
better IP degree



System setting & calibration are
protected by PIN code



Touch screen for system setting
& configuration



3 way key switch for power and control
position selection



Toggle switch for ground operation of
basket



Emergency button



“SENTAUR”

MULTIFUNCTION CONTROLLER PCU



P/N	Pkg Q.ty	Description
1097235 SENTAUR-S1	1	1-axis joystick (Dead man's switch / 2 push buttons)
1097236 SENTAUR-S2	1	2-axis joystick (Dead man's switch)



2 or 4 axis ergonomic joystick



Injection moulded upper plastic cover



Plastic back-shell injection moulded



Coloured insert
Customizable on request

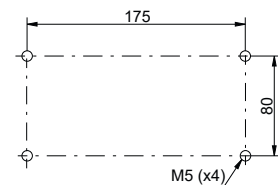
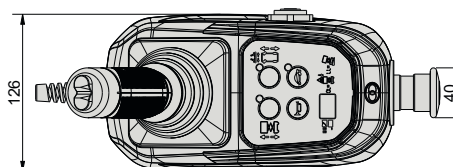
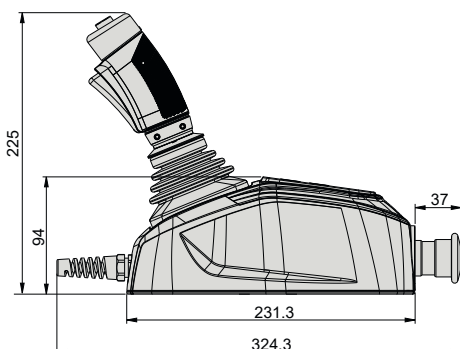

“SENTAUR”

MULTIFUNCTION CONTROLLER **PCU**



Pad printed Logo
Customizable on request



Graphic interface with protective film
Aesthetically customizable
(not buttons and display position)



Emergency button



Polycarbonate with membrane buttons
can be substituted in case of damage



“AX” JOYSTICKS

CAN BUS and HALL EFFECT



1 or 2 axes lever movement



Robust and ideal for outdoor use thanks to high sealing protection



Easy installation and connection



Space saving, reduced dimensions

CAN CAN Bus interface



Highly reliable and long lasting thanks to HALL EFFECT technology









Low power consumption



Ergonomic knob shape for fatigue-free operations

“AX” JOYSTICKS

CAN BUS and HALL EFFECT

TECHNICAL SPECIFICATIONS		
	Power supply	8 - 32V DC
	Current consumption	< 300mA
	Reverse polarity	protected
	Sealing degree	IP65 CEI EN 60529 (above the flange)
	Operating force*	7N (full stroke)
	Expected life	8.000.000 cycles
	Connection	Cable L 400 mm with connector DEUTSCH 6 pins DT04-6P-C015 OPTIONAL KIT: Mating connector P/N COBO 1028545 (27-0935-0000) <i>(Includes: connector, secondary lock, female terminals)</i>
EMC	Electromagnetic compatibility	ECE R10

* Measured at 120mm above flange face

PIN OUT	
1	+VB
2	GND
3	CAN - L
4	CAN - H
5	-
6	-

“AX-2D” JOYSTICK

- 2 Axes
- Dead man's switch

P/N	Pkg Q.ty
1099063 42-0193-0000	1

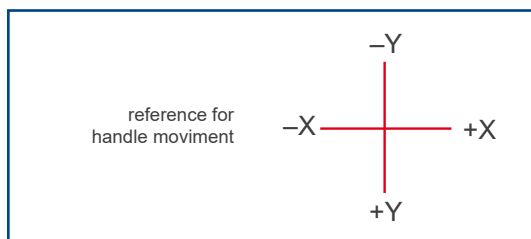
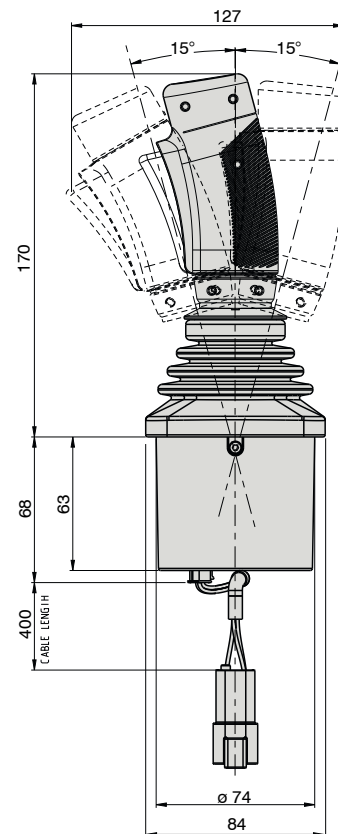
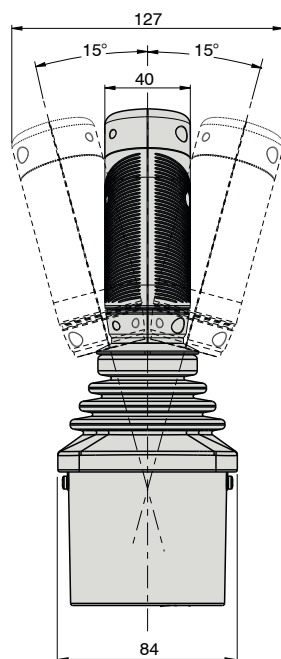
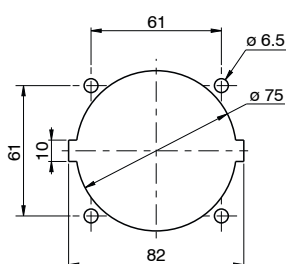

INSTALLATION

- Recommended panel thickness: 3 - 7mm.
- Fixing screws: M6 (L= panel thickness + 9mm).
- Tightening torque 5Nm.



“AX-1D” JOYSTICK

- 1 Axis
- Dead man's switch

P/N	Pkg Q.ty
1099064 42-0194-0000	1

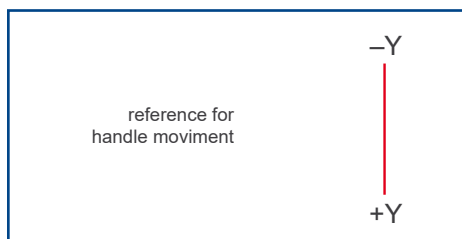
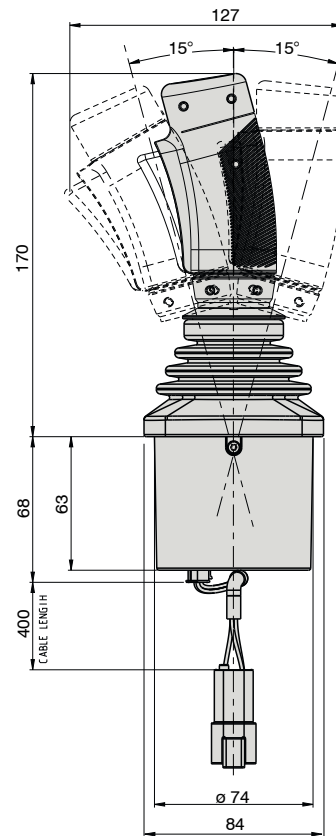
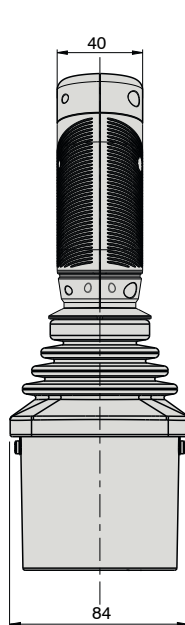
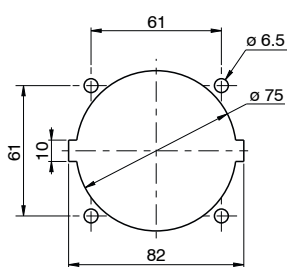

INSTALLATION

- Recommended panel thickness: 3 - 7mm.
- Fixing screws: M6 (L= panel thickness + 9mm).
- Tightening torque 5Nm.



“AX-1D2” JOYSTICK

- 1 Axis
- Dead man's switch
- 2 Push buttons

P/N	Pkg Q.ty
1099062 42-0192-0000	1

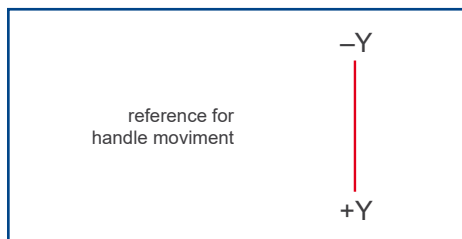
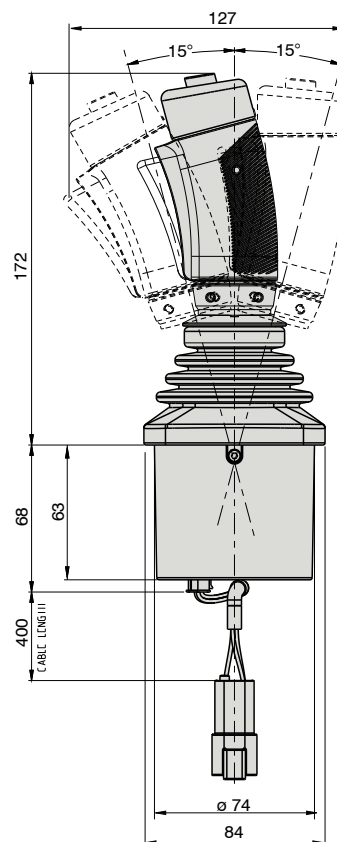
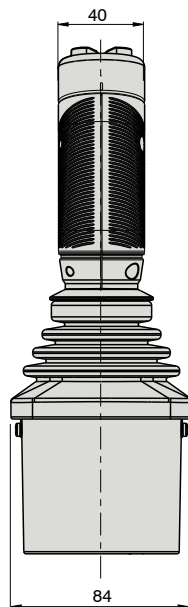
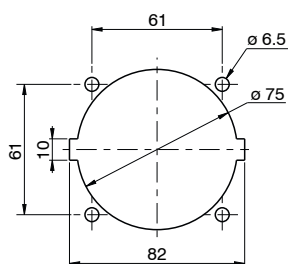

INSTALLATION

- Recommended panel thickness: 3 - 7mm.
- Fixing screws: M6 (L= panel thickness + 9mm).
- Tightening torque 5Nm.

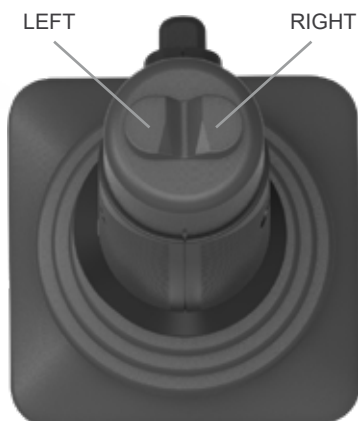

“TM” CHOPPERS

TRACTION MODULE



No matter the vehicle size and working height, same traction module for the same range of vehicle



Powerful and compact traction module



Main functions are adjustable through internal parameters



Diagnosis function for electrical motor and harness



Designed & manufactured by COBO

“TM” CHOPPERS

TRACTION MODULE

TM 1 plus GP

P/N	Pkg Q.ty
1091431 40-0032-0000	1

TECHNICAL SPECIFICATIONS

Power supply	24V
Regulation	EN12895 / EN1175
Operating temperature	-40°C ÷ +40°C
Sealing degree	IP65
Dimensions	170mm x 201mm x 68mm
Connector	AMPSEAL 26 pins
Traction motors	DC brushed
Pump motors	DC brushed
Power output	5
Digital output	3
Battery voltage	14,5 - 32V
Pump nominal current (1h) [Arms]	90
Traction nominal current (1h) [Arms]	70 + 70
Pump max current (2 min) [Arms]	200
Traction max current (2 min) [Arms]	150 + 150

Traction motors: DC brushed
Pump motors: DC brushed

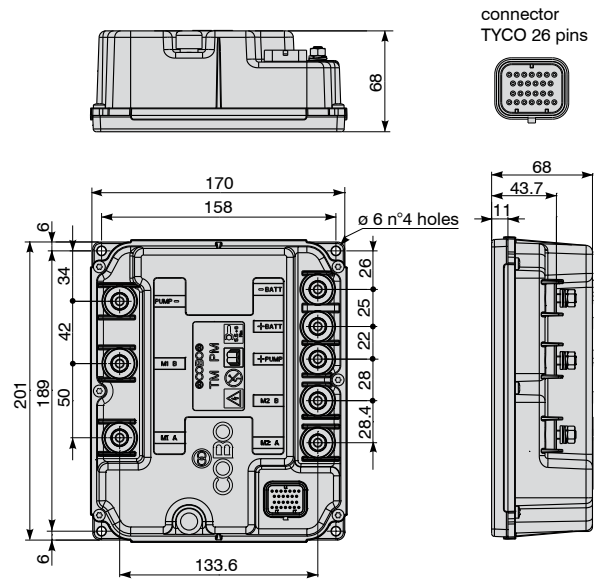

TM 2 GP

P/N	Pkg Q.ty
1091433 40-0034-0000	1

TECHNICAL SPECIFICATIONS

Power supply	24V
Regulation	EN12895 / EN1175
Operating temperature	-40°C ÷ +40°C
Sealing degree	IP65
Dimensions	177mm x 220mm x 68mm
Connector	AMPSEAL 26 pins
Traction motors	SepEx
Pump motors	DC brushed
Power output	5
Digital output	3
Battery voltage	14,5 - 32V
Pump nominal current (1h) [Arms]	125
Traction nominal current (1h) [Arms]	70 + 70
Pump max current (2 min) [Arms]	275
Traction max current (2 min) [Arms]	180 + 180
Maximum excitation current [Arms]	40

Traction motors: SepEx
Pump motors: DC brushed

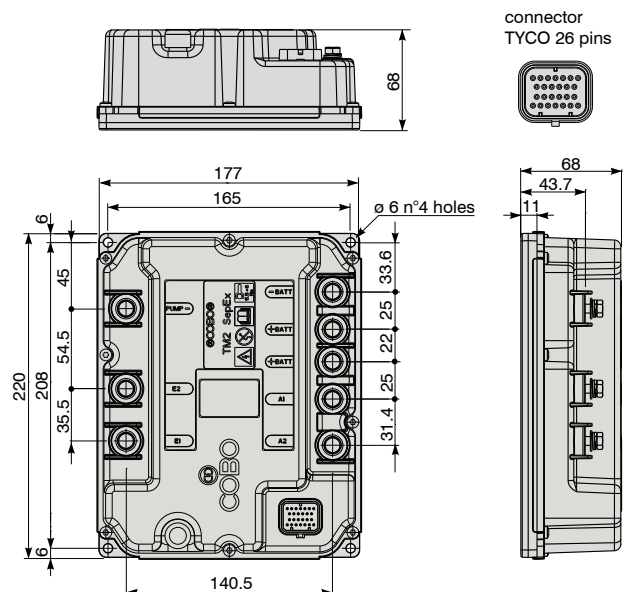

“TM” 1 plus GP / 2 GP CHOPPERS

TRACTION MODULE

APPLICATIONS

Designed to manage 2 traction motors 24V + hydraulic pump motor 24V

Typical application field: indoor AWP or compact scissors

Slave configuration, all of commands via CAN

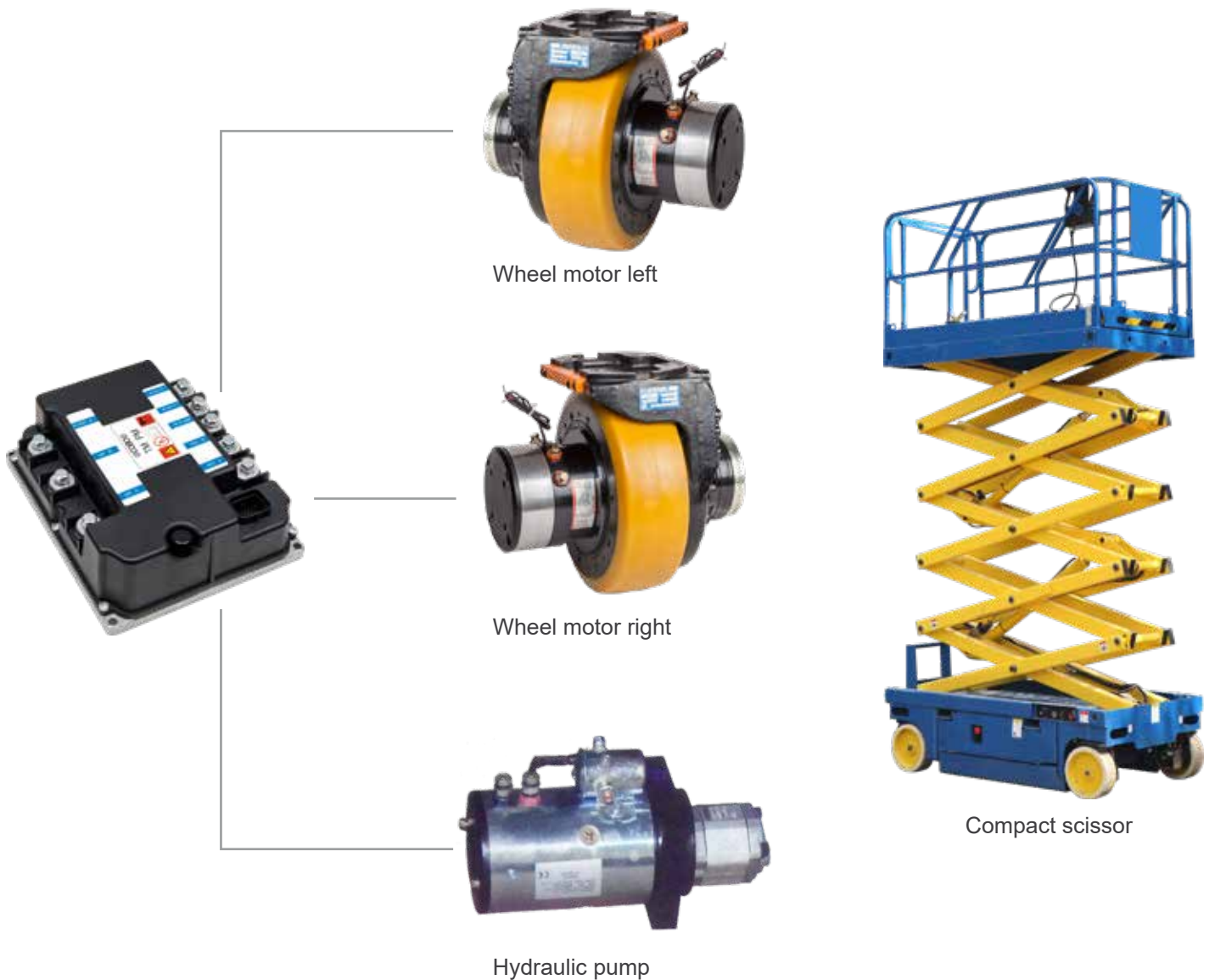

“TM” CHOPPERS

TRACTION MODULE

TM 3 GP

P/N	Pkg Q.ty
1091432 40-0033-0000	1

TECHNICAL SPECIFICATIONS

Power supply	24V
Regulation	EN12895 / EN1175
Operating temperature	-40°C ÷ +40°C
Sealing degree	IP65
Dimensions	170mm x 201mm x 68mm
Connector	AMPSEAL 26 pins
Pump motors	DC brushed or series
Power output	2
Digital output	3
Battery voltage	14,5 - 32V
Pump nominal current (1h) [Arms]	125
Pump max current (2 min) [Arms]	275

Pump motors: DC brushed or series

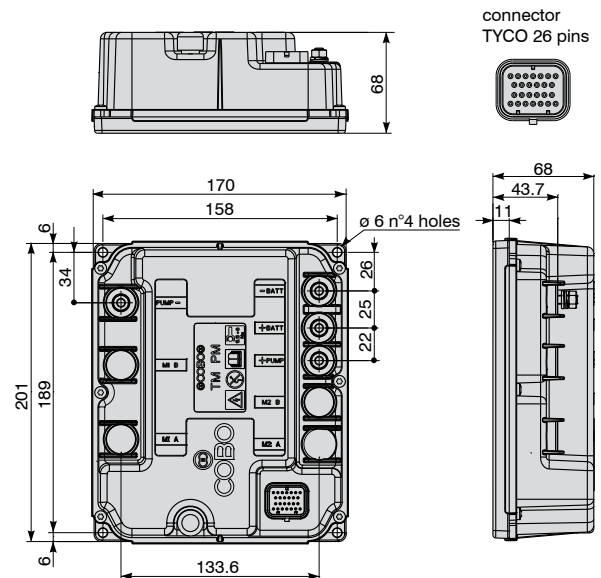

APPLICATIONS

Hydraulic pump motor 24V (DC permanent magnet or series)

Typical application field: indoor AWP or compact scissors

Slave configuration, all of commands via CAN



Hydraulic pump



Compact scissor



Note / Notes

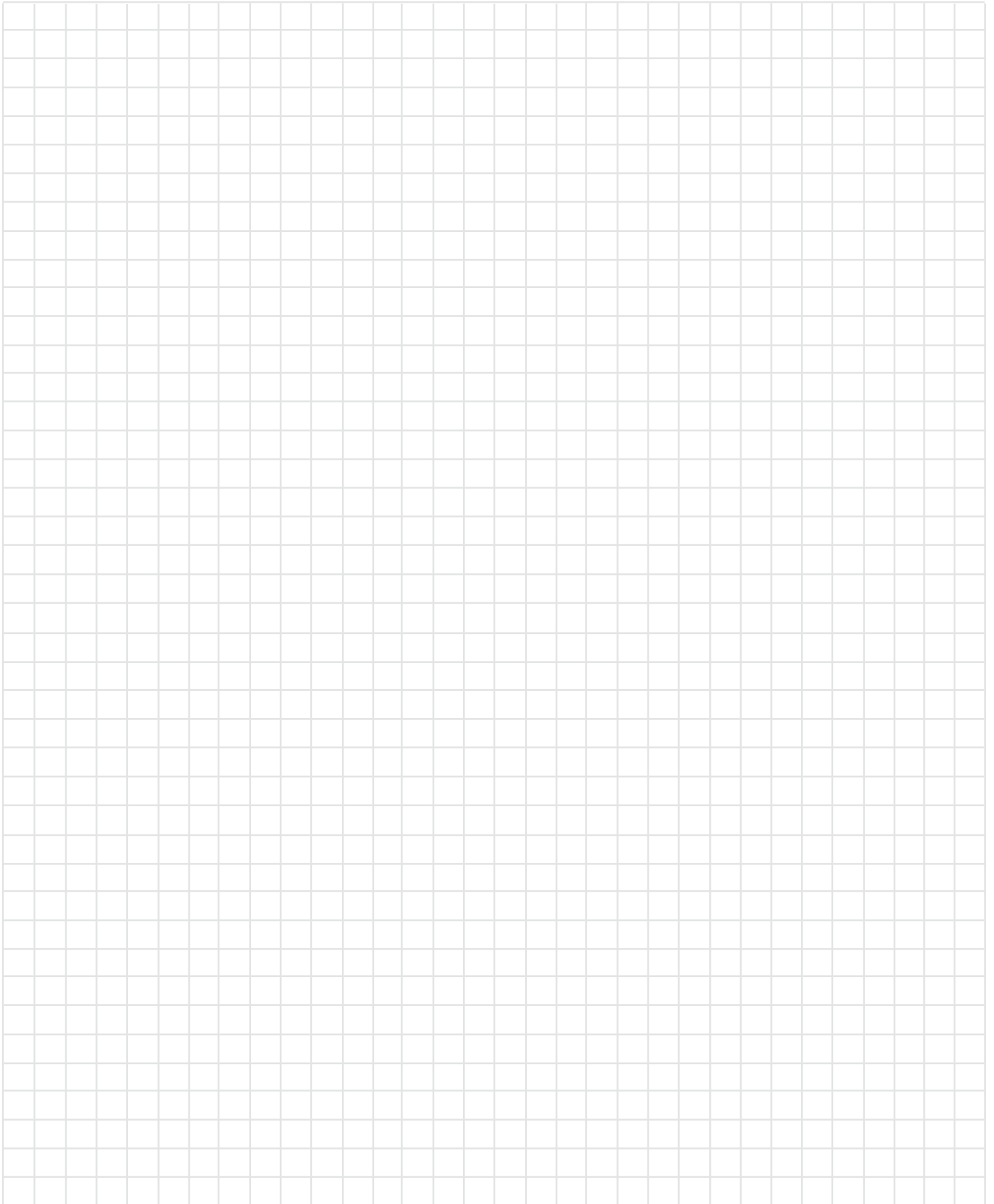

A large grid area for taking notes, consisting of a 20x20 grid of small squares. The grid is empty and occupies most of the page below the header and section title.

GERMANY



COBO DEUTSCHLAND GmbH
Zum Schürmannsgraben, 12E
D-47441 - Moers
Germany
Phone: +49 (0) 2841 88238 0
Fax: +49 (0) 2841 88238 23
E-mail: info@cobogroup.net
Web Site: www.cobo-deutschland.com

FRANCE



COBO FRANCE Sarl
Allée de l'Europe, 2 - Zone Coriolis
71210 - Ecuisses
France
Phone: +33 (0) 3 857 30560
Fax: +33 (0) 3 857 85606
E-mail: info@cobogroup.net
Web Site: www.cobofrance.com

NORTH AMERICA



COBO USA Ltd
West Division Street, 304
52655 - West Burlington
Iowa - Usa
Phone: +1 319 754 5585
Fax: +1 319 754 8724
E-mail: info@cobogroup.net
Web Site: www.cobointernational.com

LATIN AMERICA



COBO COMPONENTES AGR. E IND. Ltda
Rua Dona Francisca, 8300 - Bloco 2-M
89219-600 Zona Industrial - Joinville
Santa Catarina - Brasil
Phone: +55 47 3305 0095
E-mail: info@cobogroup.net
Web Site: www.cobogroup.net

OCEANIA



COBO OCEANIA Ltd
Maiella Street, 4/12
4207 Stapylton - Brisbane
Queensland - Australia
Phone: +61 (0) 7 3807 4866
Fax: +61 (0) 7 3807 6780
E-mail: info@cobogroup.net
Web Site: www.cobo.com.au

SOUTH-EAST ASIA



COBO ASIA Ltd
Heung Yip Road, 2 - One Island South
622 6/F Unit - Wong Chuk Hang
Hong Kong
Phone: +852 3590 3588
Fax: +852 3590 3566
E-mail: info@cobogroup.net
Web Site: www.cobogroup.net

CHINA



COBO GUANGZHOU Ltd
Qiaotou Street, 226 - Beishan - Haizhu
51000 - Guangzhou
People's Republic of China
Phone: +86 20 8922 5611
Fax +86 20 8922 5635
E-mail: info@cobogroup.net
Web Site: www.cobochina.cn

INDIA



COBO INDIA Branch Office
Mathura Road, 13/6 - 4th floor, 403
121003 NH-2 - Faridabad
Haryana - India
Phone: +91 129 4871206
Email: info@cobogroup.net
Web Site: www.cobogroup.net



C.O.B.O. SpA

Via Tito Speri, 10
25024 Leno (Brescia) ITALY
Phone +39 030 90451
Fax +39 030 9045330



info@cobogroup.net | www.cobogroup.net

Le informazioni contenute nella presente informativa hanno scopo puramente indicativo.
L'Azienda si riserva senza preavviso il diritto di apportare qualsiasi modifica tecnica del prodotto.
The information published in this catalogue is purely indicative. The Company reserves the right to introduce all technological changes of the present product at any time and without prior notice.